

MYT SERIES

ALUMINIUM HOUSING SINGLE PHASE CAPACITOR RUN ASYNCHRONOUS MOTOR

MYT series Aluminum housing single-phase capacitor-run asynchronous motors, with the international latest design, are made of quality materials and meet the relative standards of IEC. MYT series motors have following features: good performance, safe and reliable operation, nice appearance, convenient maintenance, low noise, slight vibration, light weight and simple construction.

This series motors can be used on household appliance, pumps, fans and recording meters, etc.

Operating Conditions:

Ambient temperature: $-15^{\circ}\text{C} \leq \sim \leq 40^{\circ}\text{C}$

Altitude: not exceed 1000m

Rated voltage: $\pm 5\%$



IM B3

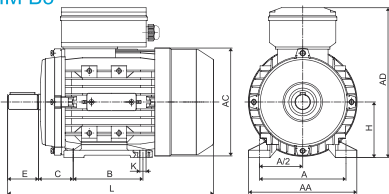

IM B5

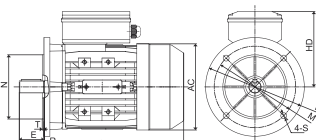

IM B14

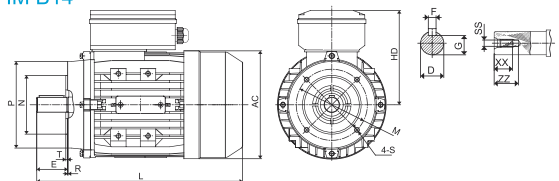

Installation Dimension

Frame Size	Mounting Dimensions																			Overall Dimensions					Shaft End Screw Dimensions				
	A	B	C	D	E	F	G	H	K	IM B14					IM B5														
										M	N	P	T	R	S	M	N	P	T	R	S	AA	AC	AD	HD	L	SS	XX	ZZ
56	90	71	36	φ9	20	3	7.2	56	5.8x8.8	φ65	φ50	φ80	2.5	0	M5	φ100	φ80	φ120	3.0	0	φ7	110	φ117	144	88	196	M3	9	12
63	100	80	40	φ11	23	4	8.5	63	7x10	φ75	φ60	φ90	2.5	0	M5	φ115	φ95	φ140	3.0	0	φ10	120	φ130	181	118	220	M4	10	14
71*	112	90	45	φ14	30	5	11	71	7x10	φ85	φ70	φ105	2.5	0	M6	φ130	φ110	φ160	3.5	0	φ10	132	φ147	196	125	241/255	M5	12	17
80	125	100	50	φ19	40	6	15.5	80	10x13	φ100	φ80	φ120	3.0	0	M6	φ165	φ130	φ200	3.5	0	φ12	160	φ163	226	146	290	M6	16	21
90S	140	100	56	φ24	50	8	20	90	10x13	φ115	φ95	φ140	3.0	0	M8	φ165	φ130	φ200	3.5	0	φ12	175	φ183	243	153	312	M8	19	25
90L	140	125	56	φ24	50	8	20	90	10x13	φ115	φ95	φ140	3.0	0	M8	φ	φ130	φ200	3.5	0	φ12	175	φ183	243	153	337/367	M8	19	25
100L**	160	140	63	φ28	60	8	24	100	12x15	φ130	φ110	φ160	3.5	0	M8	φ215	φ180	φ250	4.0	0	φ15	198	φ205	265	165	369/387	M10	22	30

Technical Data (at 50Hz)

Model	Power (kw)	Current (A)	Speed (r/min)	Eff. (%)	Power Factor (Cos)	Tst/Tn (Times)	Tmax/Tn (Times)	Starting Current (A)	Run Capacitor (μ F/V)	Noise dB(A)	W.T (kg)
MYT561-2	0.09	0.83	2740	54	0.91	0.69	1.8	2.5	4 μ F/450V	67	2.8
MYT562-2	0.12	0.98	2740	60	0.93	0.69	1.8	3.5	6 μ F/450V	67	3.05
MYT631-2	0.18	1.40	2750	62	0.93	0.7	1.8	4.5	10 μ F/450V	70	4
MYT632-2	0.25	1.80	2750	65	0.93	0.65	1.75	6	12 μ F/450V	70	4.7
MYT711-2	0.37	2.60	2640	66	0.94	0.72	1.65	8	16 μ F/450V	75	6.1
MYT712-2	0.55	3.60	2760	71	0.95	0.7	1.8	14	20 μ F/450V	75	7.7
MYT801-2	0.75	4.50	2735	73	0.98	0.68	1.75	16	30 μ F/450V	75	10.25
MYT802-2	1.1	6.60	2720	74	0.98	0.65	1.8	23	40 μ F/450V	78	11.6
MYT90S-2	1.5	8.50	2755	76	0.98	0.65	1.8	31	50 μ F/450V	80	14.55
MYT90L-2	2.2	12.30	2765	77	0.98	0.65	1.8	51	70 μ F/450V	80	17.8
MYT100L-2	3	16.90	2765	77	0.99	0.55	1.75	64	100 μ F/450V	83	23.7
MYT562-4	0.09	0.90	1370	50	0.92	0.6	1.75	3	8 μ F/450V	63	3.6
MYT631-4	0.12	1.20	1370	52	0.92	0.6	1.75	3	10 μ F/450V	65	4.45
MYT632-4	0.18	1.60	1370	54	0.94	0.6	1.6	4	12 μ F/450V	65	5.05
MYT711-4	0.25	2.00	1320	56	0.94	0.75	1.6	5	16 μ F/450V	65	6.2
MYT712-4	0.37	2.90	1325	58	0.94	0.7	1.55	7	20 μ F/450V	68	7.3
MYT801-4	0.55	3.90	1340	64	0.94	0.7	1.7	11	25 μ F/450V	73	10.05
MYT802-4	0.75	5.30	1340	64	0.94	0.7	1.75	15	35 μ F/450V	73	11.4
MYT90S-4	1.1	7.00	1355	72	0.95	0.68	1.8	22	60 μ F/450V	75	14.4
MYT90L-4	1.5	9.30	1360	74	0.95	0.68	1.8	32	70 μ F/450V	78	17.5
MYT100L 1-4	2.2	12.60	1390	78	0.97	0.48	1.75	49	80 μ F/450V	80	24.5
MYT100L 2-4	3	16.50	1380	79	0.99	0.45	1.6	61	120 μ F/450V	80	32
MYT631-6	0.09	0.92	900	46	0.92	0.8	1.45	2	8 μ F/450V	63	5.1
MYT632-6	0.12	1.05	900	54	0.92	0.75	1.45	3	11 μ F/450V	63	6
MYT711-6	0.18	1.55	900	55	0.92	0.7	1.5	4	16 μ F/450V	68	6.3
MYT712-6	0.25	2.07	900	57	0.92	0.68	1.5	5	20 μ F/450V	68	7.6
MYT801-6	0.37	2.82	900	62	0.92	0.68	1.6	8	25 μ F/450V	68	9
MYT802-6	0.55	4.08	900	63	0.93	0.68	1.6	14	30 μ F/450V	70	11.6
MYT90S-6	0.75	5.20	900	66	0.95	0.65	1.6	16	40 μ F/450V	70	13.5
MYT90L-6	1.1	7.51	900	67	0.95	0.62	1.6	25	50 μ F/450V	70	16.2

Note: MYT is high starting torque series single phase capacitor-run motors